

MOTOPLASTIC, S.A.

Molí de la sal, 1 - 08400 Granollers (Barcelona) SPAIN

Tel. 34 93 849 06 33 - Fax 34 93 849 09 88

info@puig.tv

www.puig.tv



INSTRUCCIONES DE MONTAJE - MOUNTING INSTRUCTIONS

VISERA PARA EVITAR EL "EFECTO LUPA" DE LA CÚPULA
 PLATE TO AVOID "GLASS EFFECT" OF THE SCREEN

HONDA CBR600F 11'-14'

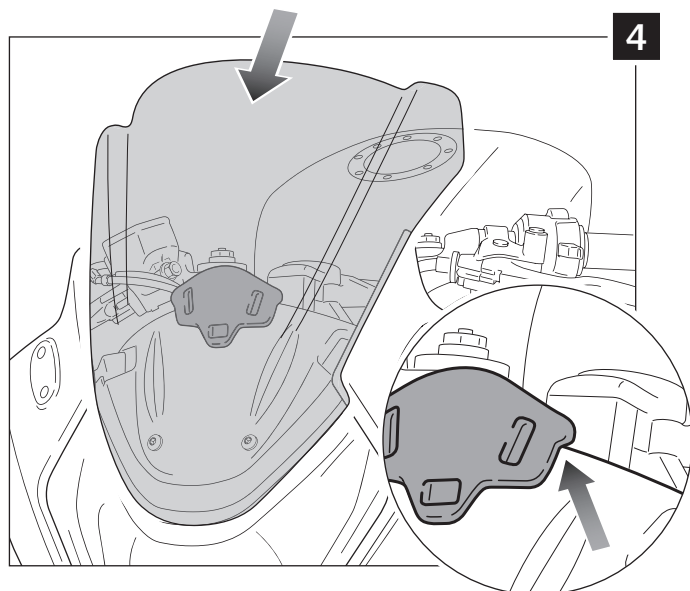
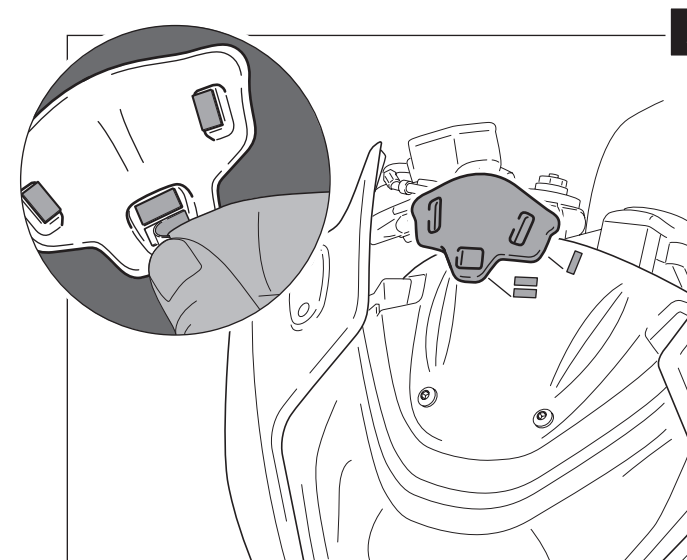
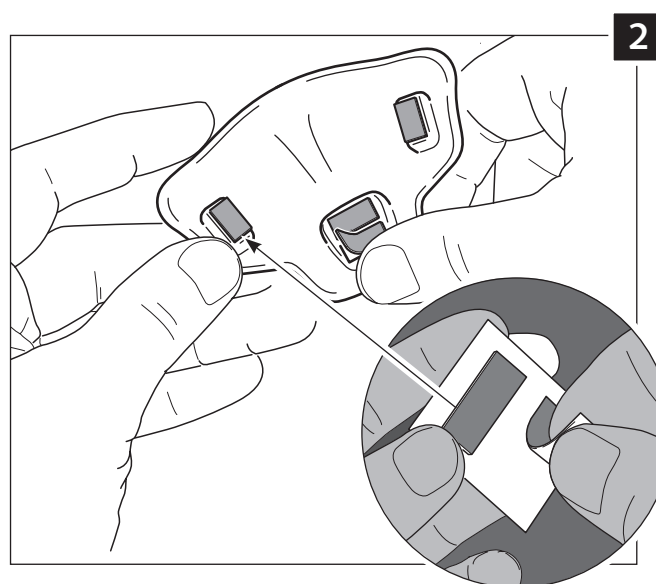
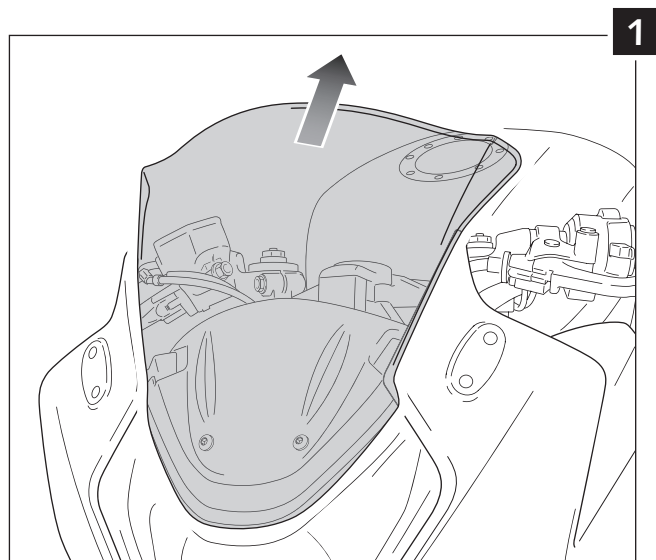
Ref.: 5637



ID.	DESCRIPCIÓN	DESCRIPTION	QTY.
1	 Visera	Plate	1
2	 Tira autoadhesiva de 2 unidades de 18mm x 7mm	Adhesive strips 2 units 18mm x 7mm	2