

PORTAVALIGIA SPECIFICO - SPECIFIC CASE HOLDER
 PORTE-VALISE SPÉCIFIQUE - SPEZIFISCHER KOFFER-TRÄGER
 PORTA-EQUIPAJE ESPECIFICO

PIAGGIO X9 125/180/250

2000/2002

ISTRUZIONI DI MONTAGGIO - MOUNTING INSTRUCTIONS
 INSTRUCTIONS DE MONTAGE - BAUANLEITUNG - INSTRUCCIONES DE MONTAJE

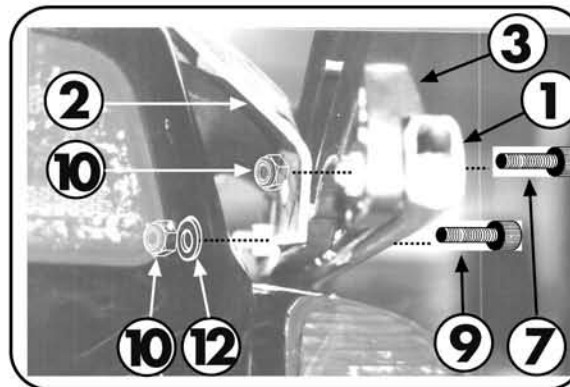
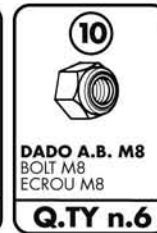
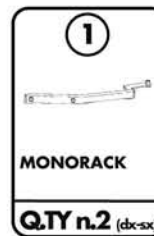
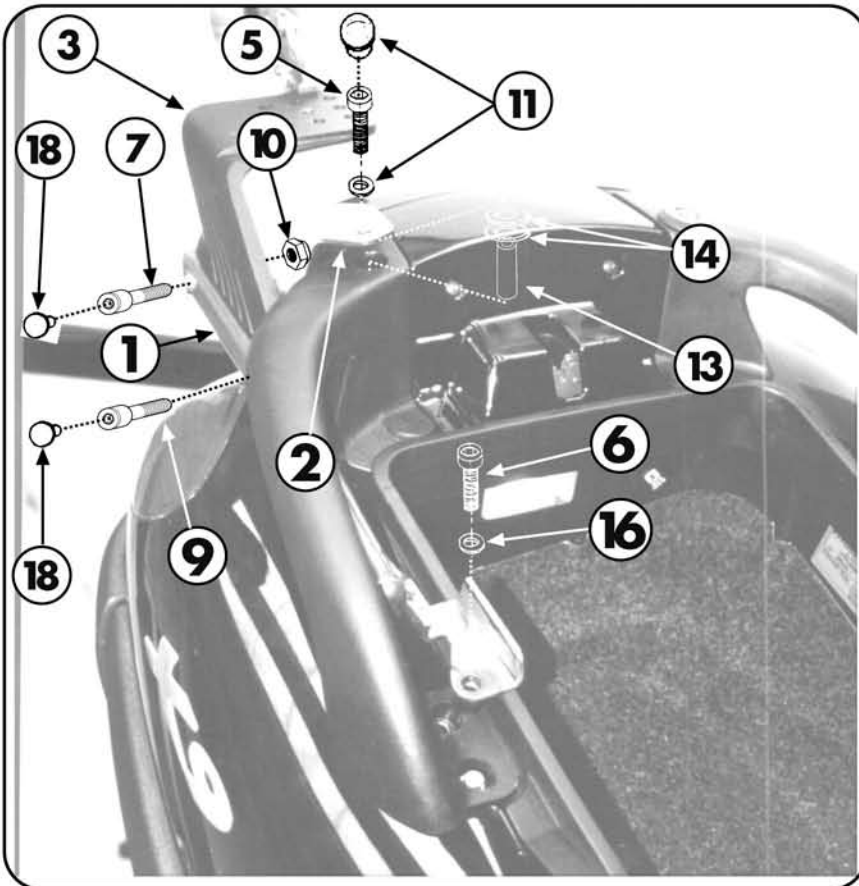

VISTA INTERNA MONTAGGIO SUPPORTO ED ALETTA POSTERIORI (pz.2 e 3)

INSIDE VIEW OF MOUNTING OF BACK SUPPORT AND FINN (pcs. 2 and 3)

VUE INTERIEURE DU MONTAGE SUPPORT ET AILETTE POSTERIEURES (pcs. 2 et 3)

