



MODEL SUZUKI GSX-R 1000

YEAR 2009-->

LINE SPORT

MUFFLER GIBLI

**SCHEMATIC**

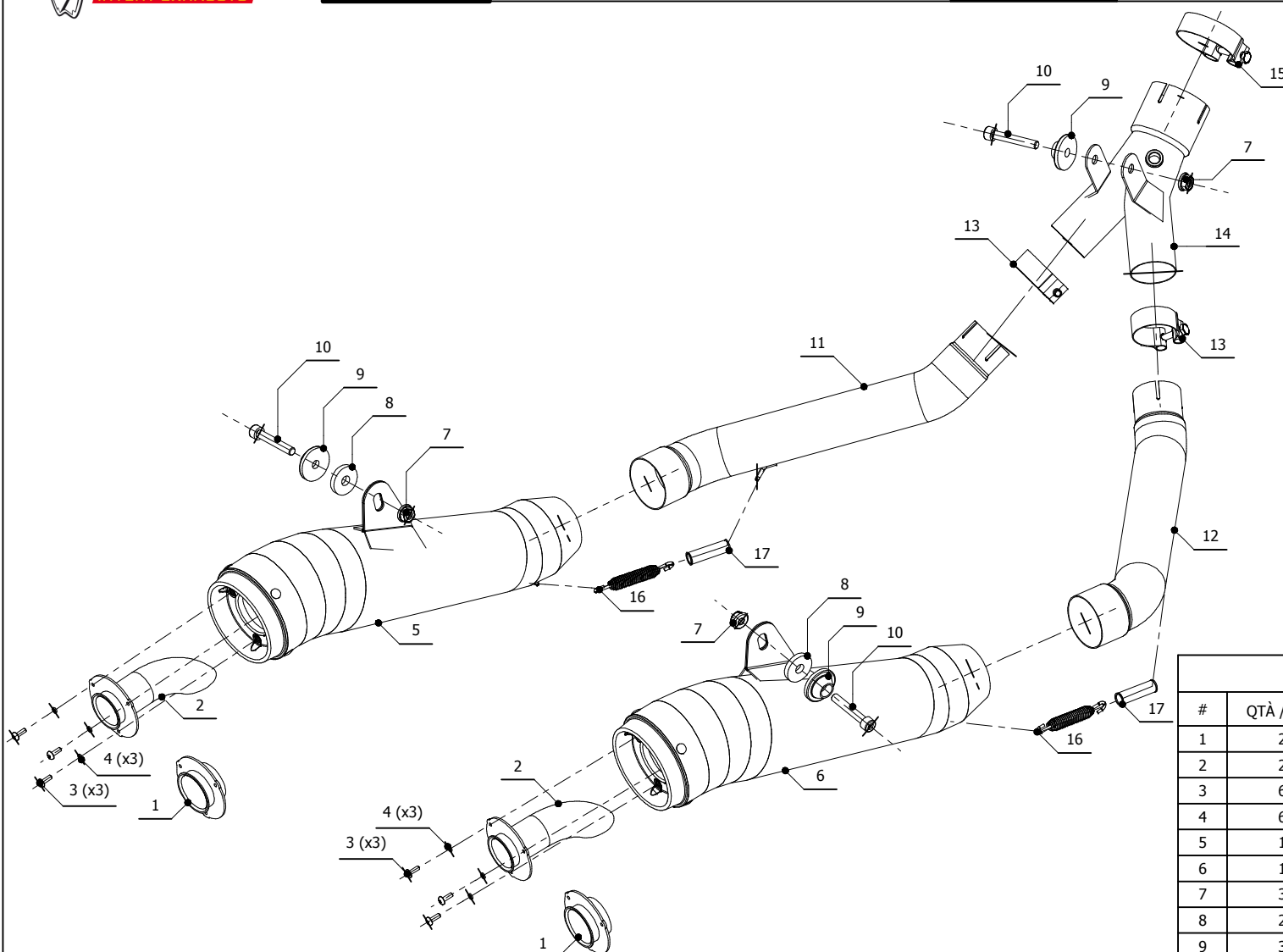

**ELENCO PARTI / PARTS LIST**

#	QTÀ / QTY	DESCRIZIONE / DESCRIPTION	CODICE / CODE
1	2	DB killer racing / Racing DB killer	50.DK.052.0
2	2	DB killer / DB killer	50.DK.051.0
3	6	Vite M4 x 12 / Screw M4 x 12	50.73.438.1
4	6	Rondella M4 / Washer M4	50.73.440.1
5	1	Silenziatore sinistro/ Left muffler	GIBLI SX
6	1	Silenziatore destro / Right muffler	GIBLI DX
7	3	Dado 8 MA flangiato / Flanged nut 8 MA	50.73.052.1
8	2	Rondella in gomma / Rubber washer	50.73.227.1
9	3	Rondella in alluminio / Aluminium washer	50.73.063.1
10	3	Vite M8x50 / Screw M8x50	50.73.074.1
11	1	Tubo di raccordo / Link pipe	9773S034SGXSX
12	1	Tubo di raccordo / Link pipe	9773S034SGDX
13	2	Fascetta Ø 44/47 mm / Pipe clamp Ø 44/47 mm	50.FA.006.1
14	1	Tubo elimina Kat / Pipe no Kat	9773S034C2
15	1	Fascetta Ø 60/63 mm / Pipe clamp Ø 60/63 mm	50.FA.010.1
16	2	Molla media / Middle spring	50.73.359.1
17	2	Tubo in gomma per molla / Rubber pipe for spring	50.73.210.1

**APPLICAZIONI / APPLICATIONS**

CODICE / CODE	TUBO / PIPE	SILENZIATORE / MUFFLER	CODICE OMOL. / HOMOL. CODE
S.034.LGX	INOX / ST. STEEL	INOX / ST. STEEL	ME033 e9 1288
S.034.LGT	TITANIO / TITANIUM	TITANIO / TITANIUM	ME033 e9 1288