



KAWASAKI Z 750 (2007 - 2009)

SLIP-ON OPEN & SLIP ON STREET LEGAL EXHAUST SYSTEM

The Akrapovic SLIP-ON series represents the first step of tuning in our product range. It is an excellent combination of price, performance and top quality materials. The sharp looking Kawasaki Z 750 will look and sound even more sporty. We offer two muffler options, one with a carbon-fiber and the other with a titanium outer sleeve. You can also choose between an open system for closed course purposes only or a homologated street legal version.

PERFORMANCE

Measurements of the Akrapovic SLIP-ON OPEN system on the Kawasaki Z 750 (without noise damper):

The linear shape of the power curve and the increased power output from low end to high end indicate the excellent design of the Akrapovic exhaust system. We measured the largest power increase of 3.8 HP at 11070 rpm. The Akrapovic SLIP-ON is even better when it comes to torque. It fills the drop-outs at around 3200 rpm, 4500 rpm and 6000 rpm beautifully, smoothing out the engine's operation. Torque is increased from 3000 rpm on and continues throughout the entire torque curve, making the engine even more responsive and user friendly.



	PERFORMANCE		
	stock	AKRAPOVIC	max. increased power
max. rear wheel power HP / rpm (measured on Dynojet ATV)	97.3 / 10600	100.3 / 10700	3.8 / 11070

weight comparison (kg)	ADDITIONAL DATA				
	stock	AKRAPOVIC		difference	
	6.14	SS link pipe	TITANIUM link pipe	stock - S.S.	stock - TITANIUM
		2.13	-	4.11	-

weight comparison (kg)	stock	AKRAPOVIC
	96dB / 5250	97.4 / 5250 (with insert)
legal for street use	YES / NO	

Technical specifications of Akrapovic exhaust systems and related products subject to change without notice.

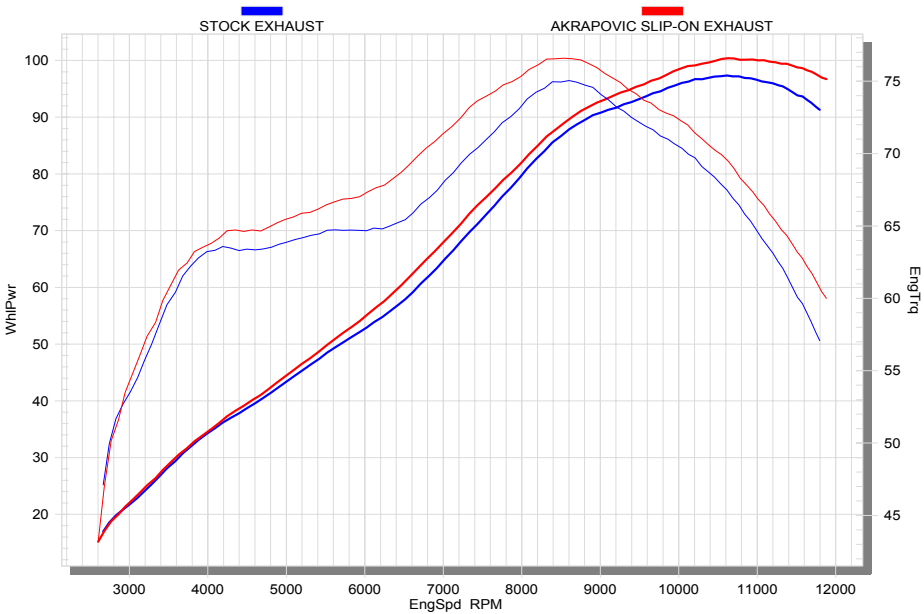

Product code: S-K7SO2-ZC (107975), S-K7SO2-ZT (107974) slip-on open
S-K7SO2C-HZT (108268) titanium, S-K7SO3-HZT (111094) stainless steel - slip-on street legal
S-K7R3-ZT/1 (109288) racing tube set with slip-on street legal muffler

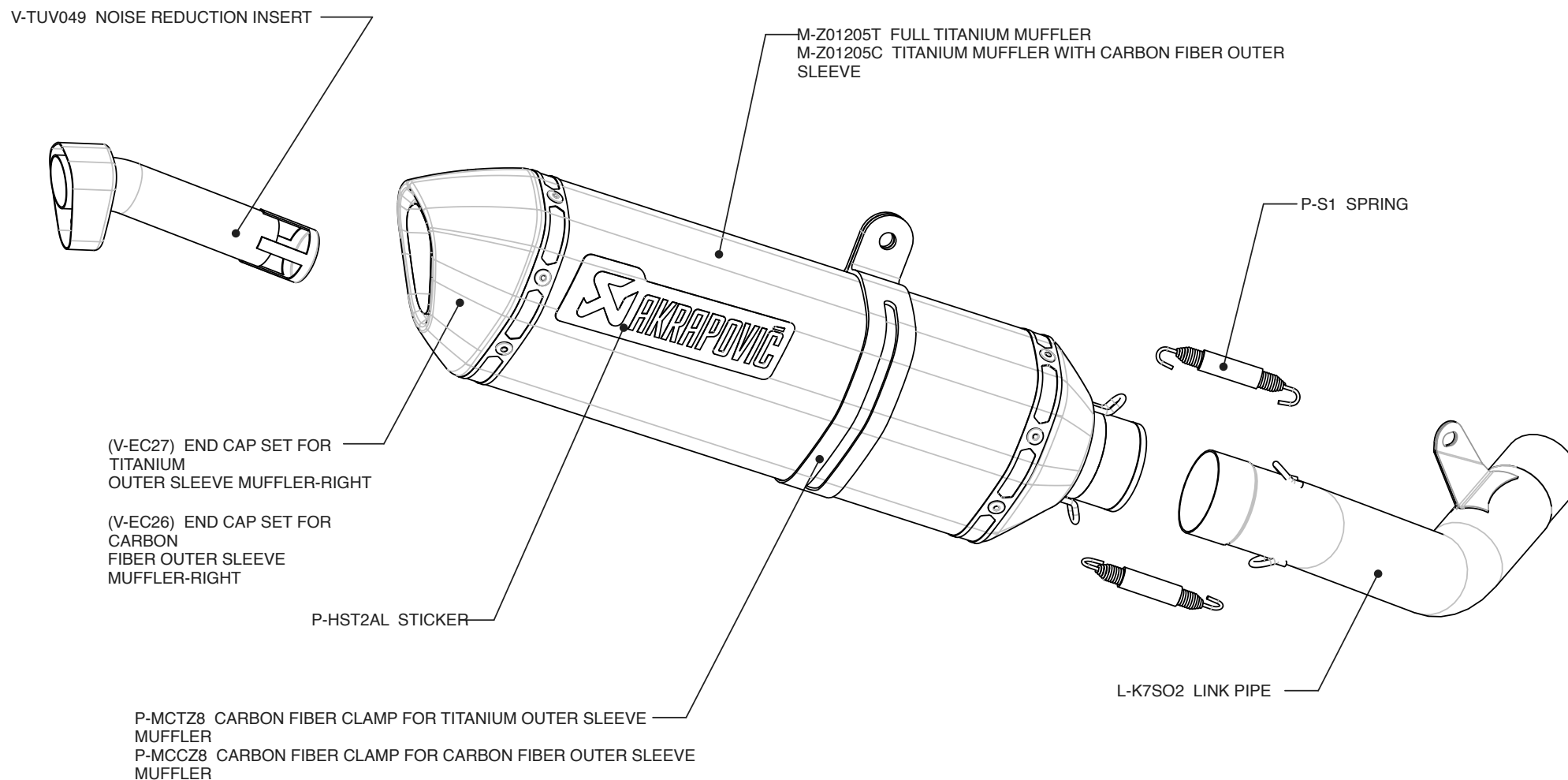

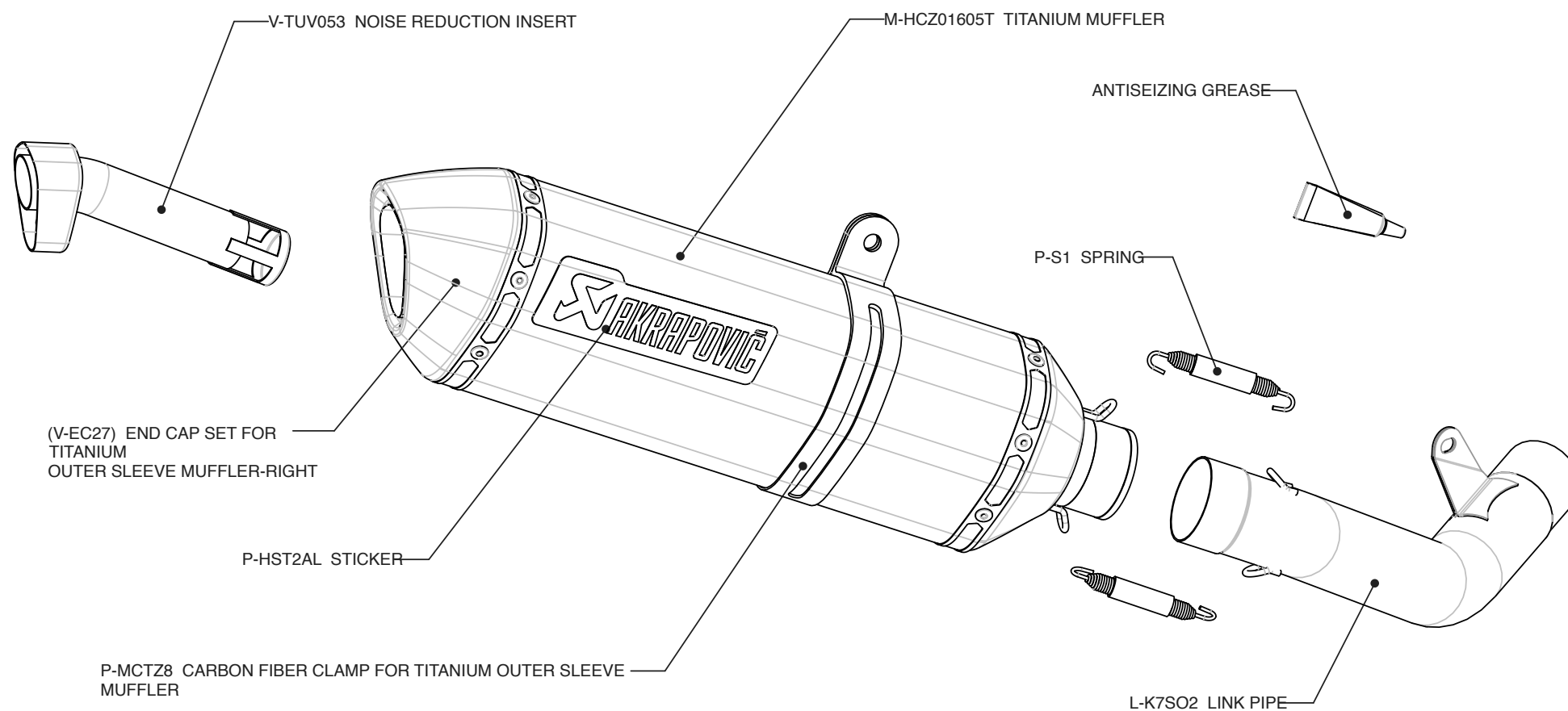

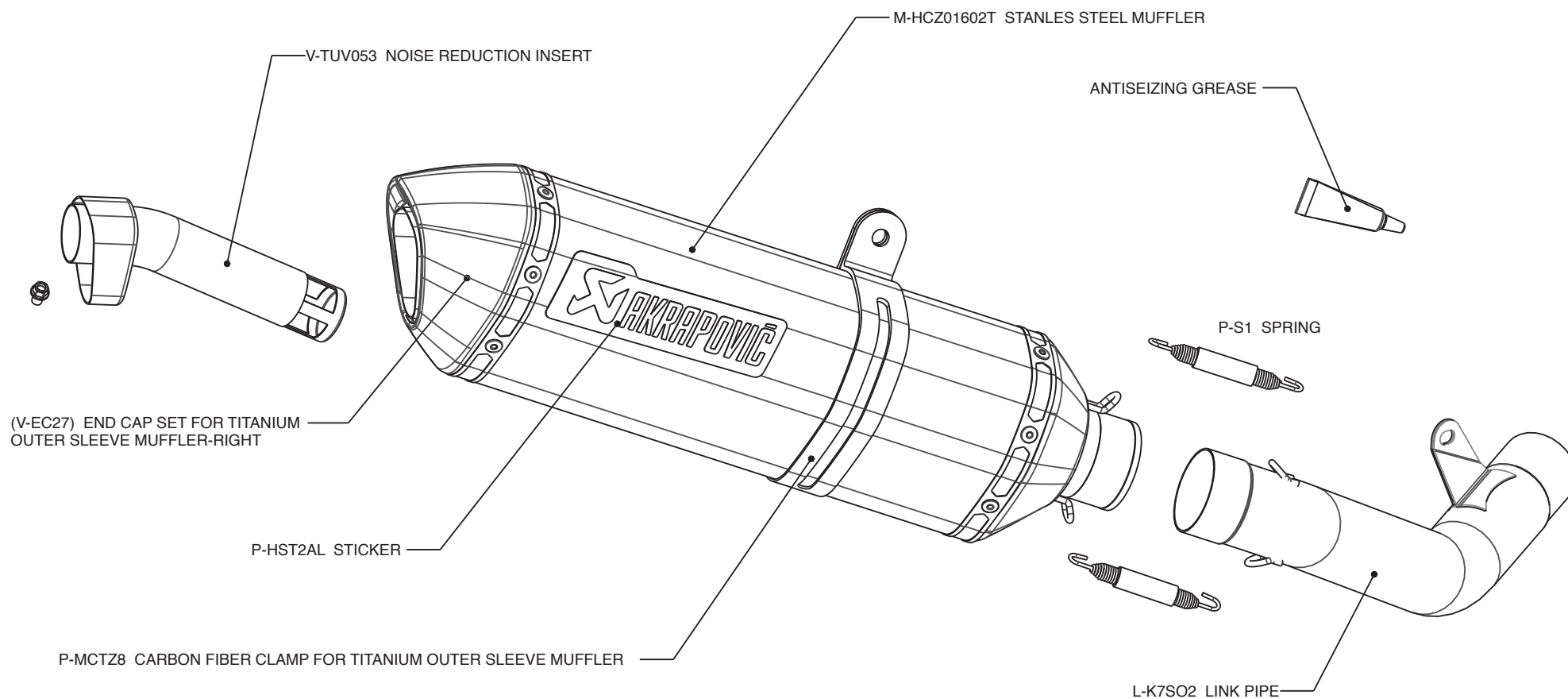

RACING LINE tube set and a street legal SLIP-ON muffler.

Warning! In case of a combination with the RACING tube set,
the SLIP-ON homologation is not valid!

