

**MOUNTING PROCEDURE****KIT WINDSHIELD  
DUCATI MONSTER 696****DN7300****KIT**

- X2. BRACKET
- X2. THICKNESS 16 MM
- X2. WASHERS Ø 8
- X2. SCREW 8X45
- X4. SCREW 5X16
- X4. AUTOLOCK NUT Ø 5
- X4. WASHER Ø 5
- X4. WASHER IN TEFLON Ø 5
- X4. RUBBER WASHER
- X1. BARRACUDA WINDSHIELD/SCREEN

WWW.BARRACUDAMOTO.COM

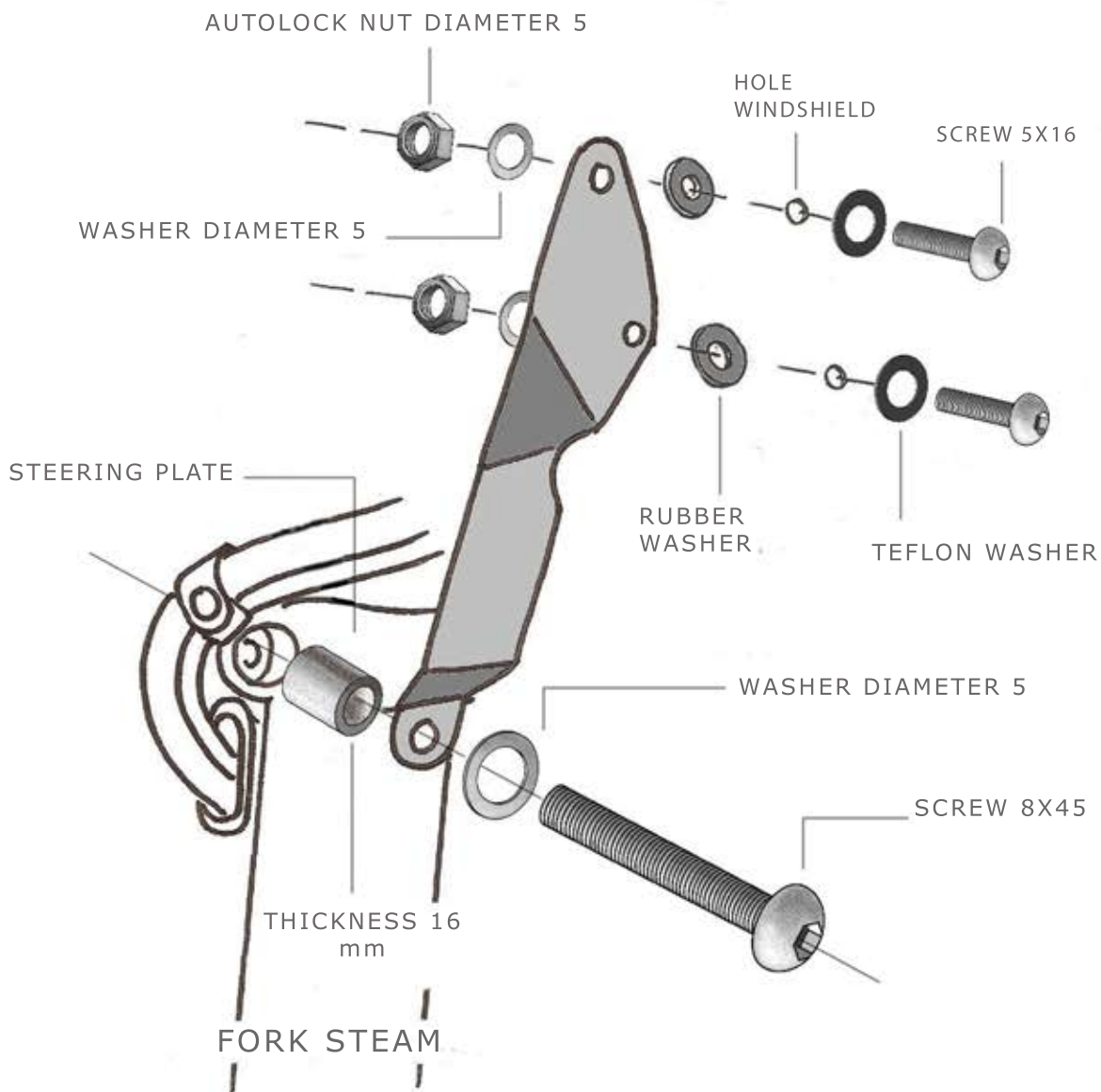

APPLY THE TWO BRACKETS ON THE LOCK OF STEERING PLATE, MOUNT THE BRACKET WITHOUT LOCK TOO MUCH, MOUNT THE PLEXIGLASS ON THE BRACKET USING THE SCREWS AND WASHERS LIKE PROCEDURE.

POSITION THE WINDSHIELD/SCREEN BUT DON'T LOCK ALL.

DON'T LOCK TOO MUCH THE SCREWS 5X16 TO AVOID DAMAGES SCREEN AFTER AND DURING THE LOCKING..

NOTE: THE PICTURE IS THE MOUNTING LEFT SIDE.